

Liquid-tight Flexible Conduit Connector

■ Die cast zinc (zinc alloy), zinc plated.



Flexible Conduit And Connector Assembly

Locknut + O-ring + Insulating Liner + Body + Ferrule + Gland Packing + Cap Nut + BLISS Flexible Conduit

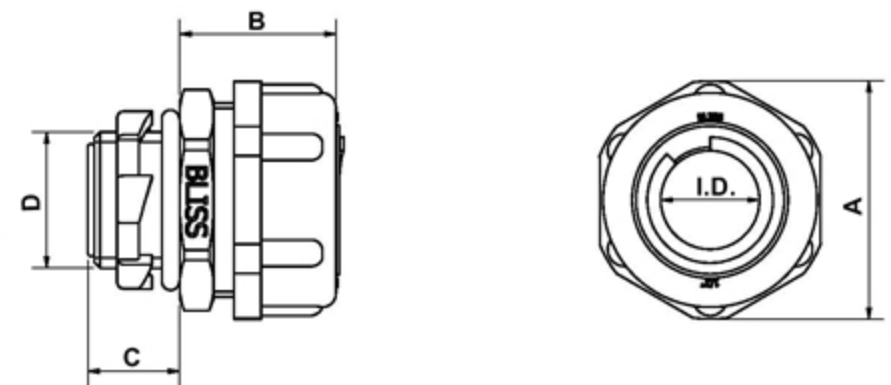

B2102

- Straight
- PF thread
- With locknut, O-ring and insulating liner
- For liquid-tight flexible metal conduit

Thread	Conduit Size (inch)	Catalog Number	Dimension (mm)					Packing (pcs)
			I.D.	A	B	C	D	
PF 1/2	3/8"	B21020300	11.5	29.0	22.0	12.0	21.0	100
PF 1/2	1/2"	B21020400	14.5	35.0	22.0	12.0	21.0	100
PF 3/4	3/4"	B21020600	19.5	42.0	27.0	16.0	26.4	50
PF 1	1"	B21021000	25.0	48.5	31.0	18.0	33.3	50
PF 1-1/4	1-1/4"	B21021200	33.5	59.0	34.5	20.5	41.9	25
PF 1-1/2	1-1/2"	B21021400	38.5	68.0	36.5	24.5	47.8	20
PF 2	2"	B21022000	49.5	82.5	43.0	27.0	59.6	10
PF 2-1/2	2-1/2"	B21022400	60.0	93.5	36.0	27.0	75.2	1
PF 3	3"	B21023000	75.0	110.0	36.0	27.0	87.9	1
PF 4	4"	B21024000	97.0	137.0	36.0	27.0	113.0	1



L2102

- 90° connector
- PF thread
- With locknut, O-ring and insulating liner
- For liquid-tight flexible metal conduit

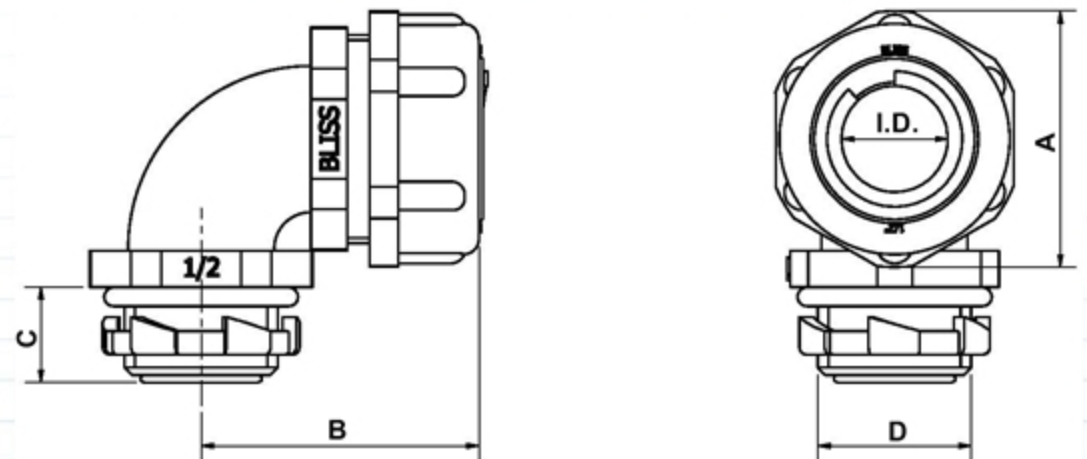

Thread	Conduit Size (inch)	Catalog Number	Dimension (mm)					Packing (pcs)
			I.D.	A	B	C	D	
PF 1/2	3/8"	L21020300	11.5	29.0	39.0	11.5	21.0	50
PF 1/2	1/2"	L21020400	14.5	35.0	39.0	12.5	21.0	50
PF 3/4	3/4"	L21020600	19.5	42.0	45.0	17.5	26.4	25
PF 1	1"	L21021000	25.0	48.5	57.0	18.0	33.3	25